

County Forest System Roads, Forest Twp Becker County Minnesota

SL105 666

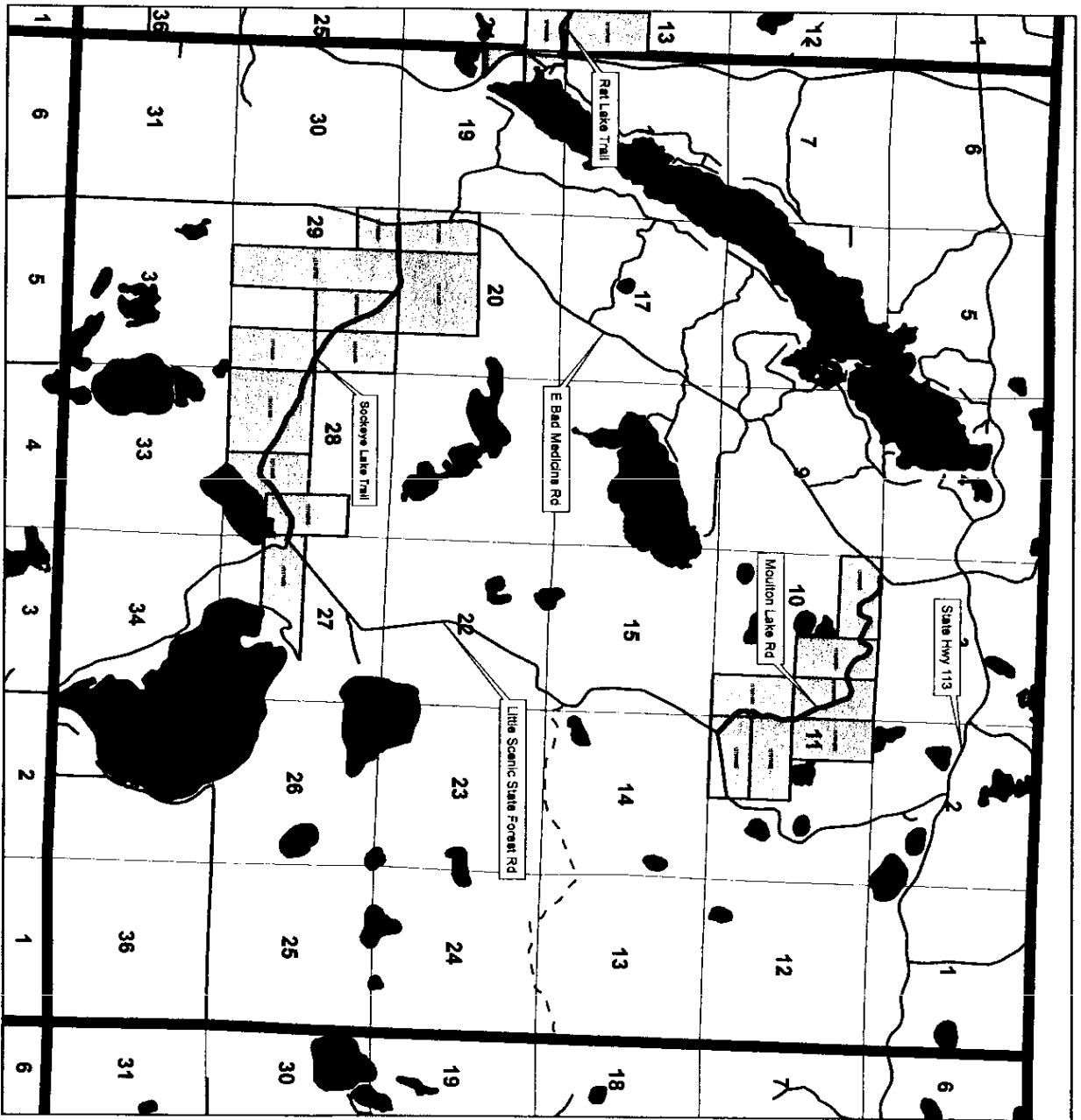

Pin	Twp_Rq	Section	CurOwner
127058000	142-37	10	BECKER COUNTY TAX FORFEITED
127058000	142-37	10	BECKER COUNTY TAX FORFEITED
127060000	142-37	10	BECKER COUNTY TAX FORFEITED
127061000	142-37	10	BECKER COUNTY TAX FORFEITED
127064000	142-37	11	BECKER COUNTY TAX FORFEITED
127072000	142-37	11	BECKER COUNTY TAX FORFEITED
127067000	142-37	12	BECKER COUNTY TAX FORFEITED
120151000	142-37	19	KRAM
127124000	142-37	20	BECKER COUNTY TAX FORFEITED
120154000	142-37	20	VLASAK
127178000	142-37	27	BECKER COUNTY TAX FORFEITED
127182000	142-37	28	BECKER COUNTY TAX FORFEITED
127183000	142-37	28	BECKER COUNTY TAX FORFEITED
120161000	142-37	28	POTLATCH OPERATING CO
127184000	142-37	29	BECKER COUNTY TAX FORFEITED
127185000	142-37	29	BECKER COUNTY TAX FORFEITED
127187000	142-37	29	BECKER COUNTY TAX FORFEITED
127188000	142-37	29	BECKER COUNTY TAX FORFEITED
127189000	142-37	29	BECKER COUNTY TAX FORFEITED

Scale: 1.97 inches = 1 mile

min maint road
 becker co forest system roads
 BeckerGIS DBO Roads, j/n/o
 parcels along system roads
 Plus TWP's Becker Clip
 Sections
 Overlaid Clip

BECKER COUNTY RECORDER
 STATE OF MINNESOTA
 Document No. 611097
 September 12, 2013 at 1:50 PM
 I hereby certify that the within
 instrument was recorded in this office
 Book P Page 66
 Of Book PARTS
 Darlene Marnel, County Recorder
 By SKS Deputy

Date of Public Hearing June 12, 2013 Date of Adoption 8/13/13 County Board Chair Dea. J. [Signature] Date 8-13-13
 County Administrator [Signature] Date 8-13-13